

# THREADED ACCESSORIES

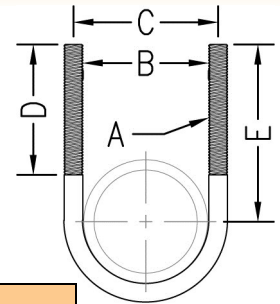

**FIG. 95**



## LIGHT DUTY U-BOLT

**Function:** Designed for use as a support, anchor, or guide for various types of pipe in light duty applications.

**Material:** Carbon steel (Type 304 or 316 Stainless Steel upon request)

**Finish:** Plain or electro-galvanized (Hot dipped galvanized upon request)

**Ordering:** Specify figure number, pipe size, material, and finish. If nuts are required, order Fig. 110 separately.

*NOTE: Regularly furnished without nuts unless specified otherwise.*

Pipe Size		Rod Size A	B		C		D		Tangent E		Max. Rec. Load		Wt. Each	
											lbs.	kN	lbs.	kg
1/2	(15)	1/4	15/16	(23.81)	13/16	(30.16)	13/4	(44.45)	115/16	(49.21)	580	(2.58)	.06	(0.03)
3/4	(20)	1/4	1 1/8	(28.58)	1 3/8	(34.93)	1 3/4	(44.45)	2 1/16	(52.39)	580	(2.58)	.07	(0.03)
1	(25)	1/4	1 3/8	(34.93)	1 5/8	(41.28)	1 3/4	(44.45)	2 3/16	(55.56)	580	(2.58)	.07	(0.03)
1 1/4	(32)	1/4	1 11/16	(42.86)	1 15/16	(49.21)	1 3/4	(44.45)	2 3/8	(60.33)	580	(2.58)	.08	(0.04)
1 1/2	(40)	1/4	2	(50.80)	2 1/4	(57.15)	1 3/4	(44.45)	2 7/16	(61.91)	580	(2.58)	.09	(0.04)
2	(50)	1/4	2 7/16	(61.91)	2 11/16	(68.26)	1 3/4	(44.45)	2 11/16	(68.26)	580	(2.58)	.10	(0.05)
2 1/2	(65)	3/8	2 15/16	(74.61)	3 5/16	(84.14)	2	(50.80)	3 1/16	(77.79)	1460	(6.49)	.28	(0.13)
3	(80)	3/8	3 9/16	(90.49)	3 15/16	(100.01)	2	(50.80)	3 3/8	(85.73)	1460	(6.49)	.31	(0.14)
3 1/2	(90)	3/8	4 1/16	(103.19)	4 7/16	(112.71)	2	(50.80)	3 5/8	(92.08)	1460	(6.49)	.35	(0.16)
4	(100)	3/8	4 9/16	(115.89)	4 15/16	(125.41)	2	(50.80)	3 7/8	(98.43)	1460	(6.49)	.38	(0.17)
5	(125)	3/8	5 5/8	(142.88)	6	(152.40)	2 1/4	(57.15)	4 9/16	(115.89)	1460	(6.49)	.45	(0.20)
6	(150)	1/2	6 3/4	(171.45)	7 1/4	(184.15)	2 1/4	(57.15)	5 1/16	(128.59)	2700	(12.01)	.95	(0.43)
8	(200)	1/2	8 3/4	(222.25)	9 1/4	(234.95)	2 1/4	(57.15)	6 1/16	(153.99)	2700	(12.01)	1.20	(0.54)
10	(250)	5/8	10 7/8	(276.23)	11 1/2	(292.10)	2 1/2	(63.50)	7 1/4	(184.15)	4320	(19.22)	2.30	(1.04)